

4

3

2

1

F

F

E

E

D

D

C

C

B

B

A

A

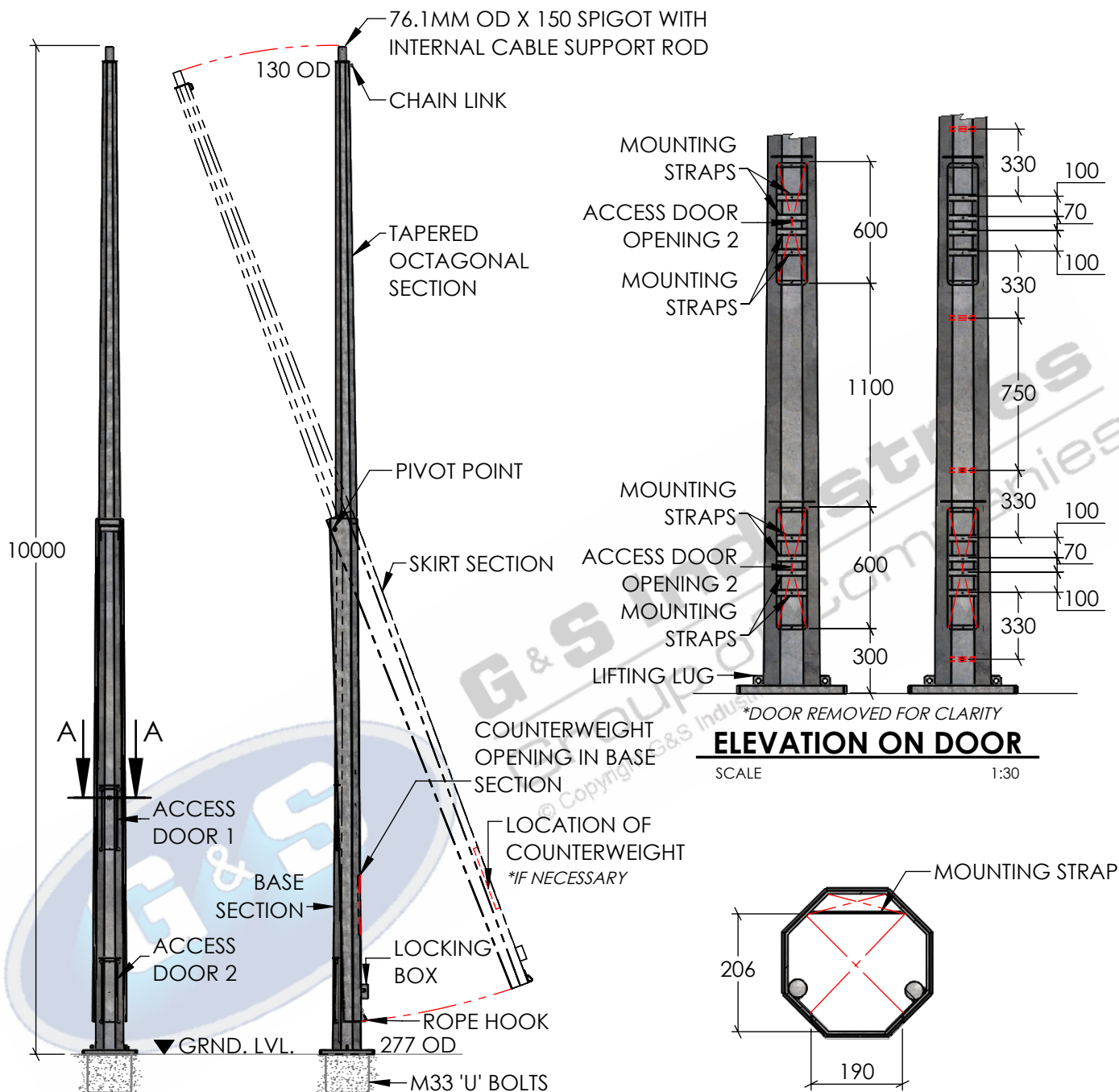

## FRONT & SIDE ELEVATION

SCALE 1:50

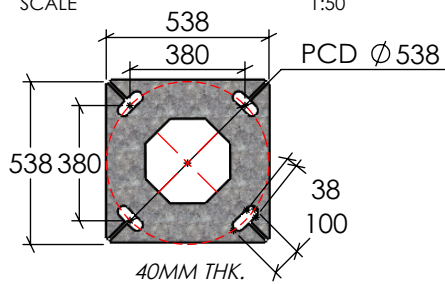

## BASEPLATE DETAILS

SCALE 1:25

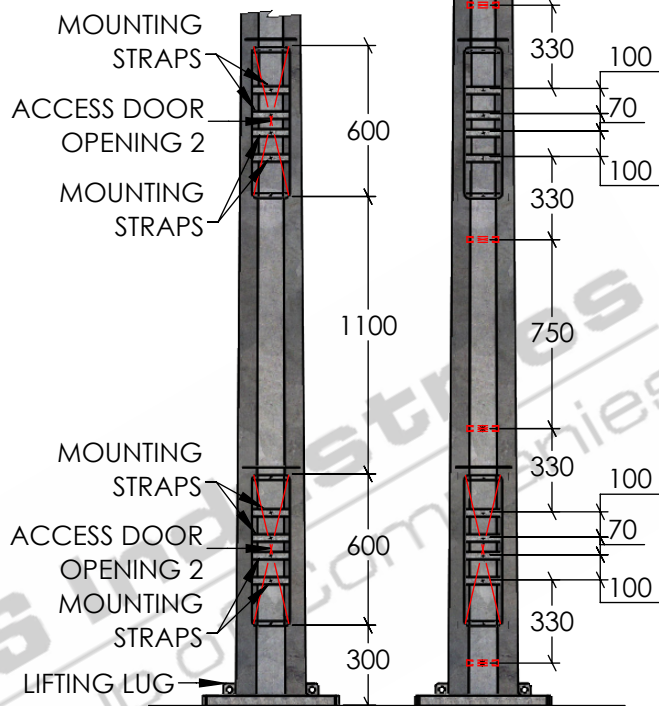

\*DOOR REMOVED FOR CLARITY

## ELEVATION ON DOOR

SCALE 1:30

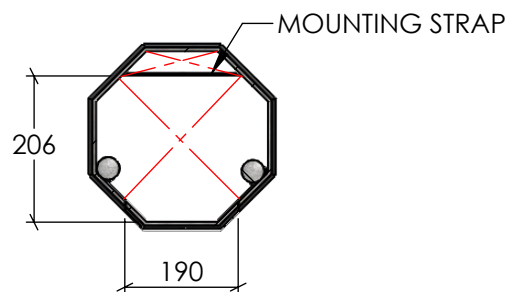

## SECTION A-A

## ACCESS DOOR CLEARANCE DETAIL

SCALE 1:10

### STANDARDS

ALL PRODUCTS TO CONFORM TO THE FOLLOWING AUSTRALIAN STANDARDS

- \* AS 1554(set) Structural steel welding set.
- \* AS 2159: Piling - Design & Installation.
- \* AS 2870: Residential slab footings - Construction.
- \* AS 3600: Concrete structures.
- \* AS 3678: Structural steel - Hot rolled plates, floorplates and slabs.
- \* AS 4680: Hot dip galvanized (Zinc) Coatings on fabricated ferrous articles.
- \* AS/NZS 4671: Steel reinforcing materials.
- \* AS/NZS 4676: Structural design requirements for utility services poles.



**G&S Industries**  
Group of Companies

97 GUTHRIE STREET,  
OSBORNE PARK W.A. 6017  
PH : +6108 9446 8044

EMAIL: sales@gsindustries.com.au  
WEB: www.gsindustries.com.au

### PROPRIETARY AND CONFIDENTIAL

THE INFORMATION CONTAINED IN THIS DRAWING IS THE SOLE PROPERTY OF G&S INDUSTRIES. ANY REPRODUCTION IN PART OR AS A WHOLE WITHOUT THE WRITTEN PERMISSION OF G&S INDUSTRIES IS PROHIBITED.

SCALE: AS SHOWN

PRODUCT FINISH: H.D.G (HOT DIPPED GALVANIZED)

PRODUCT WEIGHT: 460kg.

CUSTOMER APPROVAL:

CUSTOMER NAME / PROJECT:

NAME

DATE

PART NUMBER:

MH10BHH

DRAWN: N.C. A.

04.06.2020

CHECKED: RG

04.06.2020

REVISED: N.C. A.

30.06.2020

TITLE:

**10M EXTRA HEAVY DUTY  
MID-HINGED BASE MOUNTED  
TAPERED OCTAGONAL POLE**

### COPYRIGHT

THIS DOCUMENT IS PRODUCED BY G&S INDUSTRIES  
MUST NOT BE COPIED, TRACED, REPRODUCED,  
OR LENT WITHOUT WRITTEN CONSENT

SIZE

DWG. NO.

ZLRG2065A

REV.

0

SHEET 1 OF 1

4

3

2

1