

4

3

2

1

F

F

E

E

D

D

C

C

B

B

A

A

F

E

D

C

B

A

76.1 OD X 150MM SPIGOT

82 OD

MOUNTING STRAP

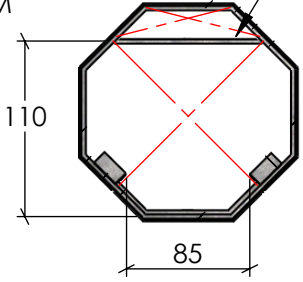

SECTION A-A

**ACCESS DOOR CLEARANCE DETAIL**

SCALE 1:5

ACCESS DOOR OPENING

MOUNTING STRAPS

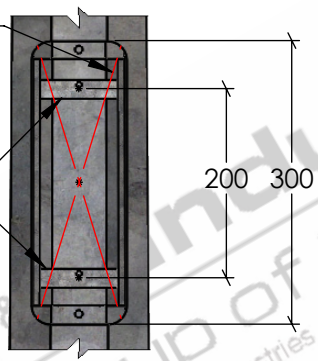

\*DOOR REMOVED FOR CLARITY

**ELEVATION ON DOOR**

SCALE 1:8

TAPERED OCTAGONAL SECTION

5000

A A

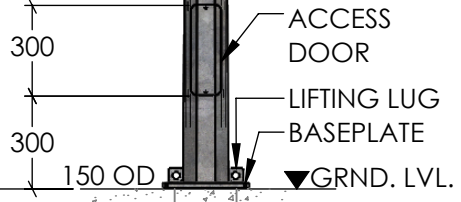

**FRONT ELEVATION**

SCALE 1:8

4 X (M16) HD BOLTS

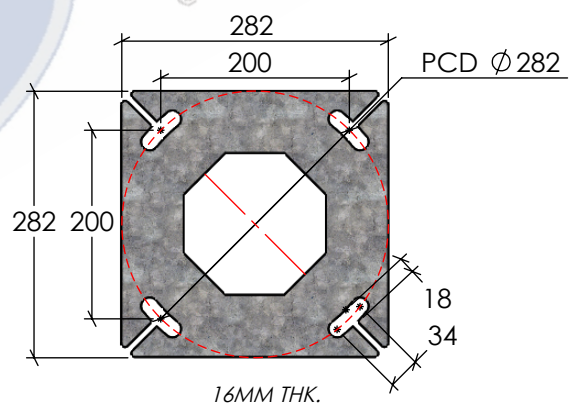

**BASEPLATE DETAILS**

SCALE 1:8

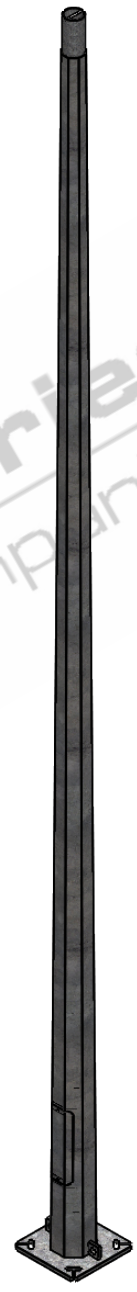

**ISOMETRIC**

SCALE 1:25

STANDARDS

- ALL PRODUCTS TO CONFORM TO THE FOLLOWING AUSTRALIAN STANDARDS
- \* AS 1554(set) Structural steel welding set.
- \* AS 2159: Piling - Design & Installation.
- \* AS 2870: Residential slab footings - Construction.
- \* AS 3600: Concrete structures.
- \* AS 3678: Structural steel - Hot rolled plates, floorplates and slabs.
- \* AS 4680: Hot dip galvanized (Zinc) Coatings on fabricated ferrous articles.
- \* AS/NZS 4671: Steel reinforcing materials.
- \* AS/NZS 4676: Structural design requirements for utility services poles.



**G&S Industries**  
 Group of Companies  
 97 GUTHRIE STREET,  
 OSBORNE PARK W.A. 6017  
 PH : +6108 9446 8044  
 EMAIL: sales@gsindustries.com.au  
 WEB: www.gsindustries.com.au

<b>PROPRIETARY AND CONFIDENTIAL</b>	
THE INFORMATION CONTAINED IN THIS DRAWING IS THE SOLE PROPERTY OF G&S INDUSTRIES. ANY REPRODUCTION IN PART OR AS A WHOLE WITHOUT THE WRITTEN PERMISSION OF G&S INDUSTRIES IS PROHIBITED.	
SCALE: AS SHOWN	PRODUCT WEIGHT: 55.0kg.
PRODUCT FINISH: H.D.G (HOT DIPPED GALVANIZED)	CUSTOMER APPROVAL:
CUSTOMER NAME / PROJECT:	

NAME	DATE	PART NUMBER : <b>F5BM</b>
DRAWN N.C. A.	04.06.2020	
CHECKED RG	04.06.2020	
REVISED N.C. A.	30.06.2020	
<b>COPYRIGHT</b>		TITLE : <b>5M MEDIUM DUTY FIXED BASE MOUNTED TAPERED OCTAGONAL POLE</b>
THIS DOCUMENT IS PRODUCED BY G&S INDUSTRIES MUST NOT BE COPIED, TRACED, REPRODUCED, OR LENT WITHOUT WRITTEN CONSENT		
SIZE <b>A4</b>	DWG. NO. <b>ZLRG2035</b>	REV. <b>0</b>

4

3

2

1