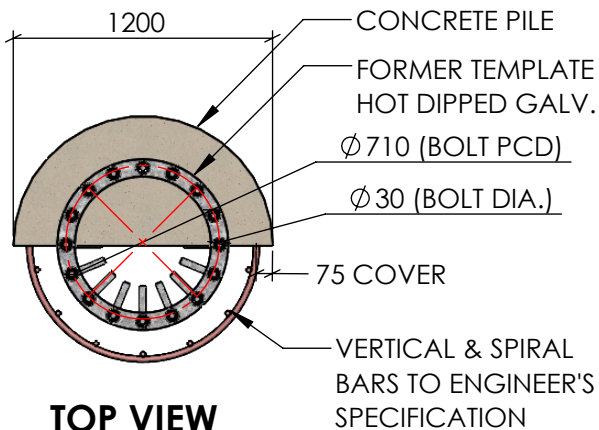

4

3

2

1

**TOP VIEW**

SCALE 1:30

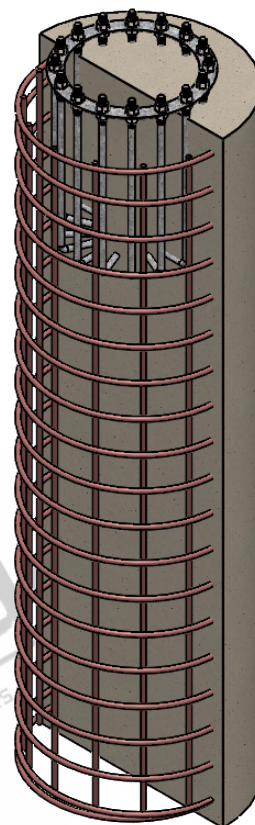
**ISOMETRIC ELEVATION**

SCALE 1:30

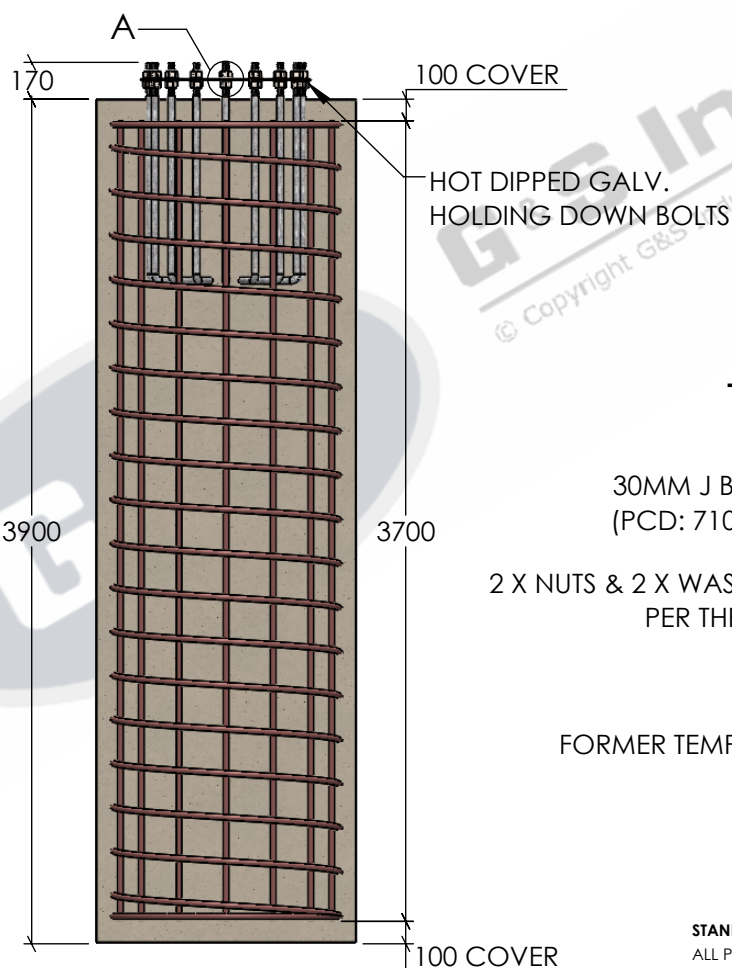
**SIDE ELEVATION**

SCALE 1:30

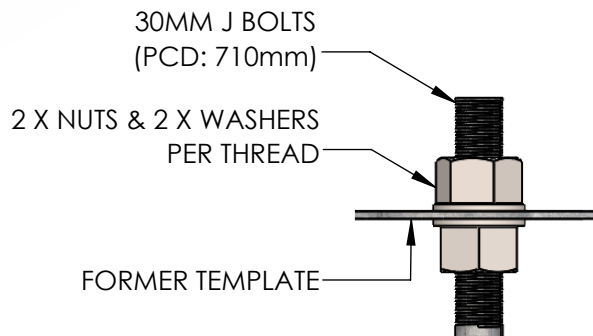
**DETAIL A**  
SCALE 1:5**STANDARDS**

ALL PRODUCTS TO CONFORM TO THE FOLLOWING AUSTRALIAN STANDARDS.

- \* AS 1170.2 Structural design actions - Wind actions.
- \* AS 1554(set) Structural steel welding set.
- \* AS 2159: Piling - Design & Installation.
- \* AS 2870: Residential slab footings - Construction.
- \* AS 3600: Concrete structures.
- \* AS 3678: Structural steel - Hot rolled plates, floorplates and slabs.
- \* AS 4680: Hot dip galvanized (Zinc) Coatings on fabricated ferrous articles.
- \* AS/NZS 4671: Steel reinforcing materials.
- \* AS/NZS 4600: Cold formed steel structures.

\*PILE & CAGE LENGTH MAY VARY WITH SOIL TYPE.  
CONCRETE POURED ON SITE. RECOMMENDED STRENGTH 32MPa.

**G & S Industries**

97 GUTHRIE STREET,  
OSBORNE PARK W.A. 6017  
PH : +6108 9446 8044  
EMAIL: sales@gsindustries.com.au  
WEB: www.gsindustries.com.au

**PROPRIETARY AND CONFIDENTIAL**

THE INFORMATION CONTAINED IN THIS DRAWING IS THE SOLE PROPERTY  
OF G&S INDUSTRIES. ANY REPRODUCTION IN PART OR AS A WHOLE  
WITHOUT THE WRITTEN PERMISSION OF G&S INDUSTRIES IS PROHIBITED.

SCALE: AS SHOWN PRODUCT WEIGHT: 241.6kg.  
\*NOT INCLUDING THE CONCRETE PILE

PRODUCT FINISH: HOT DIPPED GALVANIZED

CUSTOMER APPROVAL:

CUSTOMER NAME / PROJECT:

NAME

DATE

PART NUMBER:

**CR30/16/710**

DRAWN

N. A.

14.10.2022

CHECKED

S. G.

14.10.2022

APPROVED

R. G.

14.10.2022

TITLE:

**30MM (16 BOLT) 710 PCD  
CAGED RAGBOLT ASSEMBLY  
SUIT PILE TYPE FOOTING  
FULLY WELDED AND ASSEMBLED**

**COPYRIGHT**

THIS DOCUMENT IS PRODUCED BY G&S INDUSTRIES  
MUST NOT BE COPIED, TRACED, REPRODUCED,  
OR LENT WITHOUT WRITTEN CONSENT

SIZE

**A4**

DWG. NO.

**ZLRG2396**

REV.

**0**

SHEET 1 OF 1

4

3

2

1