

1 2 3 4

A

A

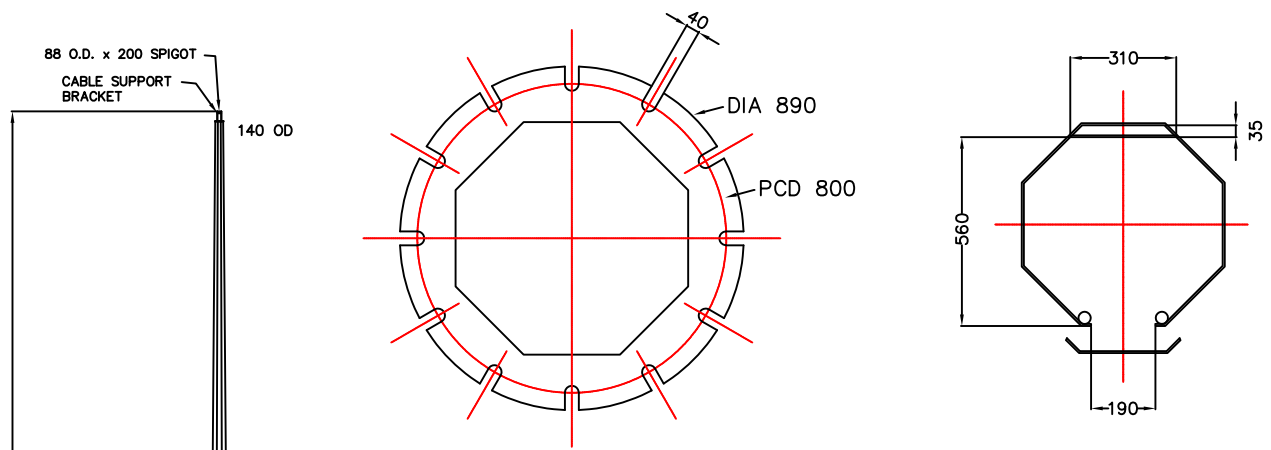

BASEPLATE THICKNESS: 32mm
BASEPLATE DETAILS

CONTROL GEAR CLEARANCE DETAILS

B

B

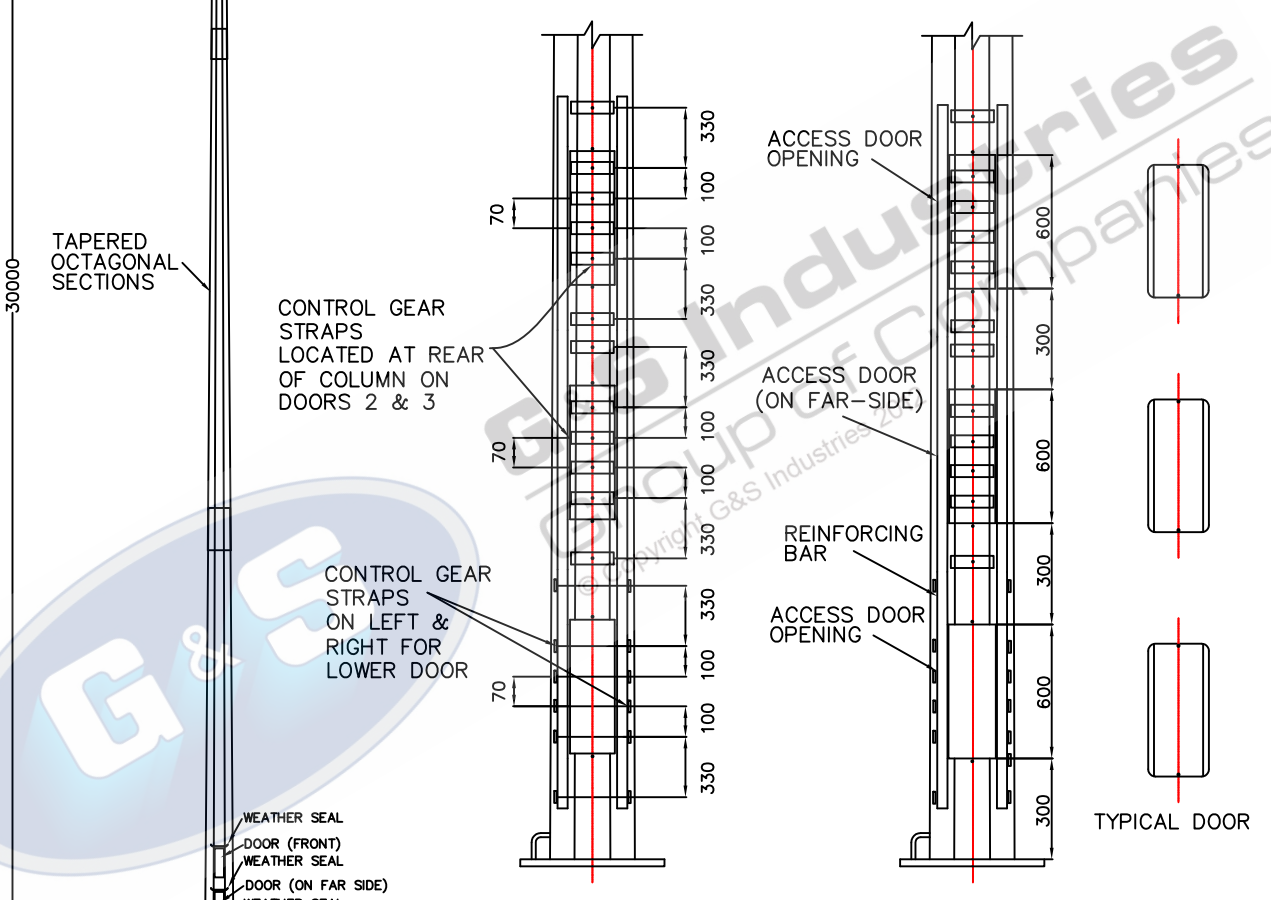

CONTROL GEAR STRAPS LOCATED AT REAR OF COLUMN ON DOORS 2 & 3

CONTROL GEAR STRAPS ON LEFT & RIGHT FOR LOWER DOOR

ACCESS DOOR OPENING

ACCESS DOOR (ON FAR-SIDE)

REINFORCING BAR

ACCESS DOOR OPENING

TYPICAL DOOR

ELEVATION ON DOORS

8 SETS OF CONTROL GEAR STRAPS ON BOTH SIDES OF COLUMN DOORS REMOVED FOR CLARITY

D

D

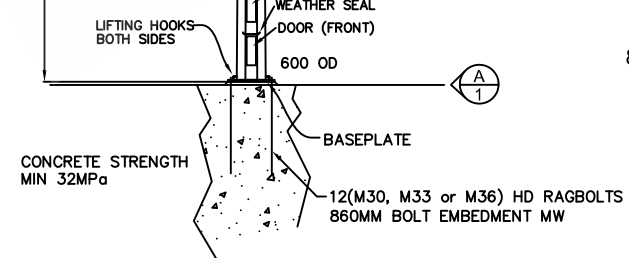

ELEVATION

TOTAL WEIGHT OF COLUMN: 2057.00KG'S

- STANDARDS**
ALL PRODUCTS TO CONFORM TO THE FOLLOWING AUSTRALIAN STANDARDS
- * AS 1170.2: Structural design actions – Wind actions.
 - * AS 1302: Geometrical product specifications indication of surface texture in technical production documentation.
 - * AS 1554(set) Structural steel welding set.
 - * AS 2159: Piling – Design & Installation.
 - * AS 2870: Residential slab footings – Construction.
 - * AS 3600: Concrete structures.
 - * AS 3678: Structural steel – Hot rolled plates, floorplates and slabs.
 - * AS 4680: Hot dip galvanized (Zinc) Coatings on fabricated ferrous articles.
 - * AS/NZS 4671: Steel reinforcing materials.
 - * AS/NZS 4600: Cold formed steel structures.
 - * AS/NZS 4676: Structural design requirements for utility services poles.
- NOTE: All welds to be 6mm Continuous Fillet Weld Category Structural Purpose unless otherwise noted.

E

E



97 GUTHRIE STREET, OSBORNE PARK W.A. 6017
PH (08) 9446 8044. (08) 9446 8266
FAX (08) 9446 5456

JOB NO.	DATE:	DESIGN:	S.G.	DRAWN:	Z.L.
30M FIXED TAPERED OCTAGONAL COLUMN F30BM		CHECKED:	R.G.	APPROVED:	Y
		LAST REVISED:	22 SEP '10	SCALE:	NTS
		DRAWING:	ZLRG2059BCA	REVISION:	03

1 2 3 4