

1

2

3

4

A

A

B

B

C

C

D

D

88 O.D. x 200 SPIGOT
CABLE SUPPORT
BRACKET

162 OD

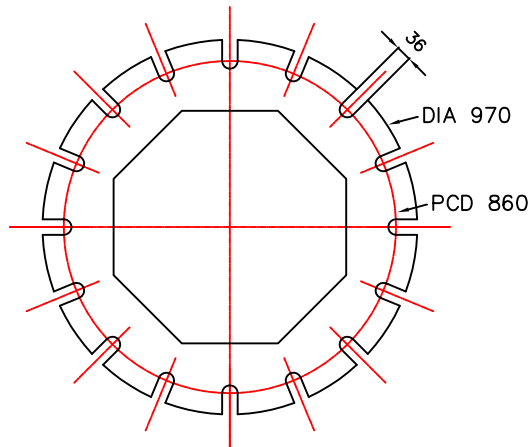

BASEPLATE THICKNESS: 40mm
BASEPLATE DETAILS

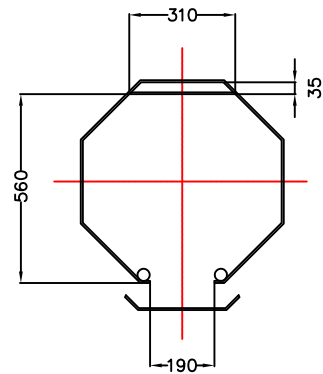

**CONTROL GEAR
CLEARANCE DETAILS**

30000

TAPERED
OCTAGONAL
SECTIONS

CONTROL GEAR
STRAPS
LOCATED AT REAR
OF COLUMN ON
DOORS 2 & 3

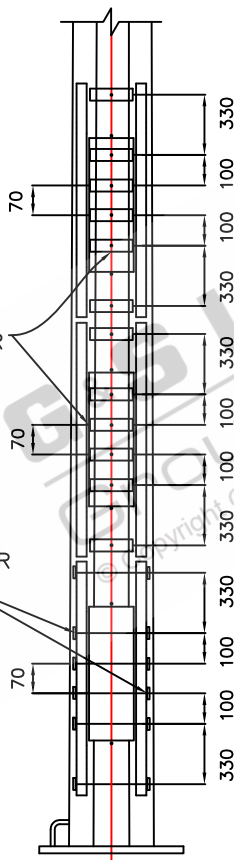

CONTROL GEAR
STRAPS
ON LEFT &
RIGHT FOR
LOWER DOOR

ACCESS DOOR
OPENING

ACCESS DOOR
(ON FAR-SIDE)

REINFORCING
BAR

ACCESS DOOR
OPENING

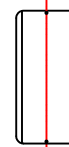
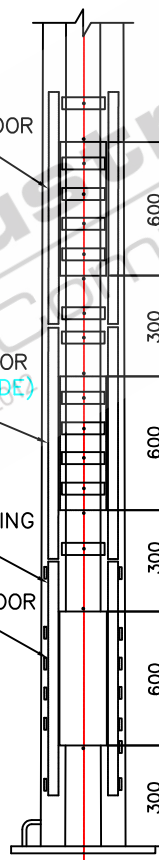

TYPICAL DOOR

ELEVATION ON DOORS

8 SETS OF CONTROL GEAR STRAPS ON BOTH SIDES OF COLUMN
DOORS REMOVED FOR CLARITY

WEATHER SEAL
DOOR (FRONT)
WEATHER SEAL
DOOR (REAR)
WEATHER SEAL
DOOR (FRONT)

LIFTING HOOKS
BOTH SIDES

600 OD



BASEPLATE

16(M30 or M33) HD RAGBOLTS

ELEVATION

TOTAL WEIGHT OF COLUMN: 2527.00KG'S

STANDARDS

- ALL PRODUCTS TO CONFORM TO THE FOLLOWING AUSTRALIAN STANDARDS
- * AS 1170.2: Structural design actions - Wind actions.
- * AS 1302: Geometrical product specifications indication of surface texture in technical production documentation.
- * AS 1554(set): Structural steel welding set.
- * AS 2159: Piling - Design & Installation.
- * AS 2870: Residential slab footings - Construction.
- * AS 3600: Concrete structures.
- * AS 3678: Structural steel - Hot rolled plates, floorplates and slabs.
- * AS 4680: Hot dip galvanized (Zinc) Coatings on fabricated ferrous articles.
- * AS/NZS 4671: Steel reinforcing materials.
- * AS/NZS 4600: Cold formed steel structures.
- * AS/NZS 4676: Structural design requirements for utility services poles.



G&S Industries

97 GUTHRIE STREET, OSBORNE PARK W.A. 6017
PH (08) 9446 8044. (08) 9446 8266
FAX (08) 9446 5456

JOB NO.

DATE:

DESIGN:

S.G.

DRAWN:

Z.L.

30M FIXED TAPERED OCTAGONAL COLUMN
F30BHH

CHECKED:

R.G.

APPROVED:

Y

LAST REVISED:

13 MAY '09

SCALE:

NTS

DRAWING:

ZLRG2058BCA

REVISION:

01

1

2

3

4

E

E