

1

2

3

4

A

A

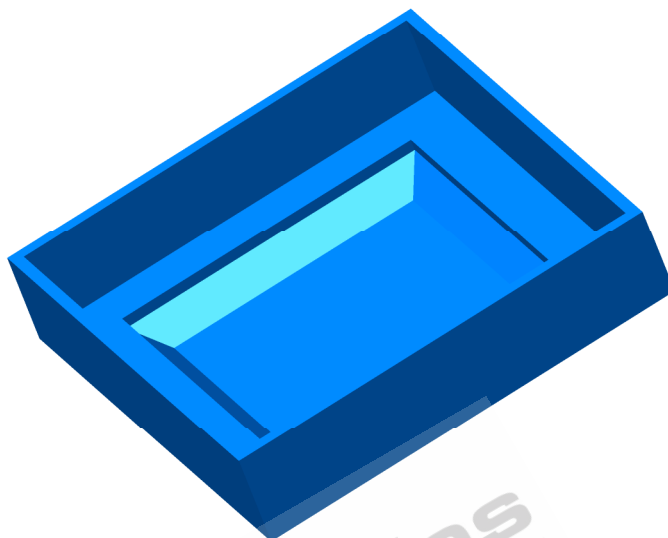
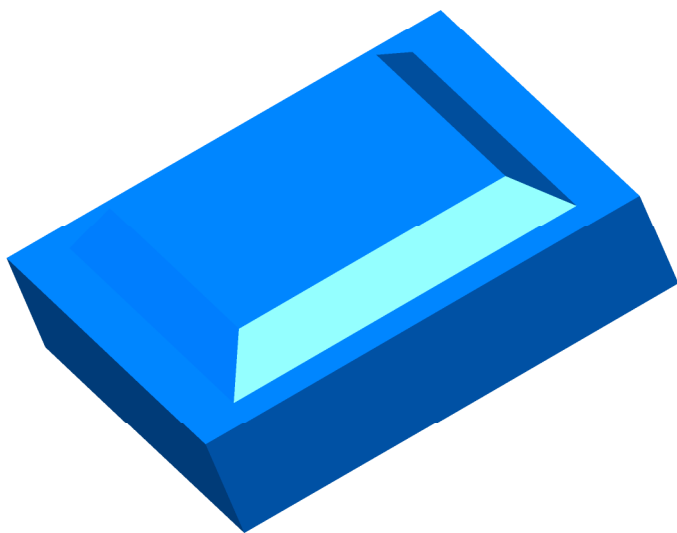

B

B

C

C

D

D

E

E

**G & S Industries**  
Group of Companies

ITEM	ITEM WEIGHT (GRAMS)	PART NO	ALT PART NO
100mm SQUARE SHS PIPE CAP	235	CAPSQ100	890260
125mm SQUARE SHS PIPE CAP	525	CAPSQ125	890261
150mm SQUARE SHS PIPE CAP	460	CAPSQ150	890262

STANDARDS  
ALL PRODUCTS TO CONFORM TO THE FOLLOWING AUSTRALIAN STANDARDS

- \* AS 1170.2: Structural design actions - Wind actions.
- \* AS 1302: Geometrical product specifications Indication of surface texture in technical production documentation.
- \* AS 1554(set) Structural steel welding set.
- \* AS 2159: Piling - Design & Installation.
- \* AS 2870: Residential slab footings - Construction.
- \* AS 3600: Concrete structures.
- \* AS 3678: Structural steel - Hot rolled plates, floorplates and slabs.
- \* AS 4680: Hot dip galvanized (Zinc) Coatings on fabricated ferrous articles.
- \* AS/NZS 4671: Steel reinforcing materials.
- \* AS/NZS 4600: Cold formed steel structures.
- \* AS/NZS 4676: Structural design requirements for utility services poles.



G&S Industries

97 GUTHRIE STREET, OSBORNE PARK W.A. 6017  
PH (08) 9446 8044. (08) 9446 8266  
FAX (08) 9446 5456

JOB NO.

DATE:

DESIGN:

S.G.

DRAWN:

Z.L.

SHS CAPS

CHECKED:

R.G.

APPROVED:

Y

LAST REVISED:

4 SEPT '06

SCALE:

NTS

DRAWING:

ZLRG2204

REVISION:

01

1

2

3

4